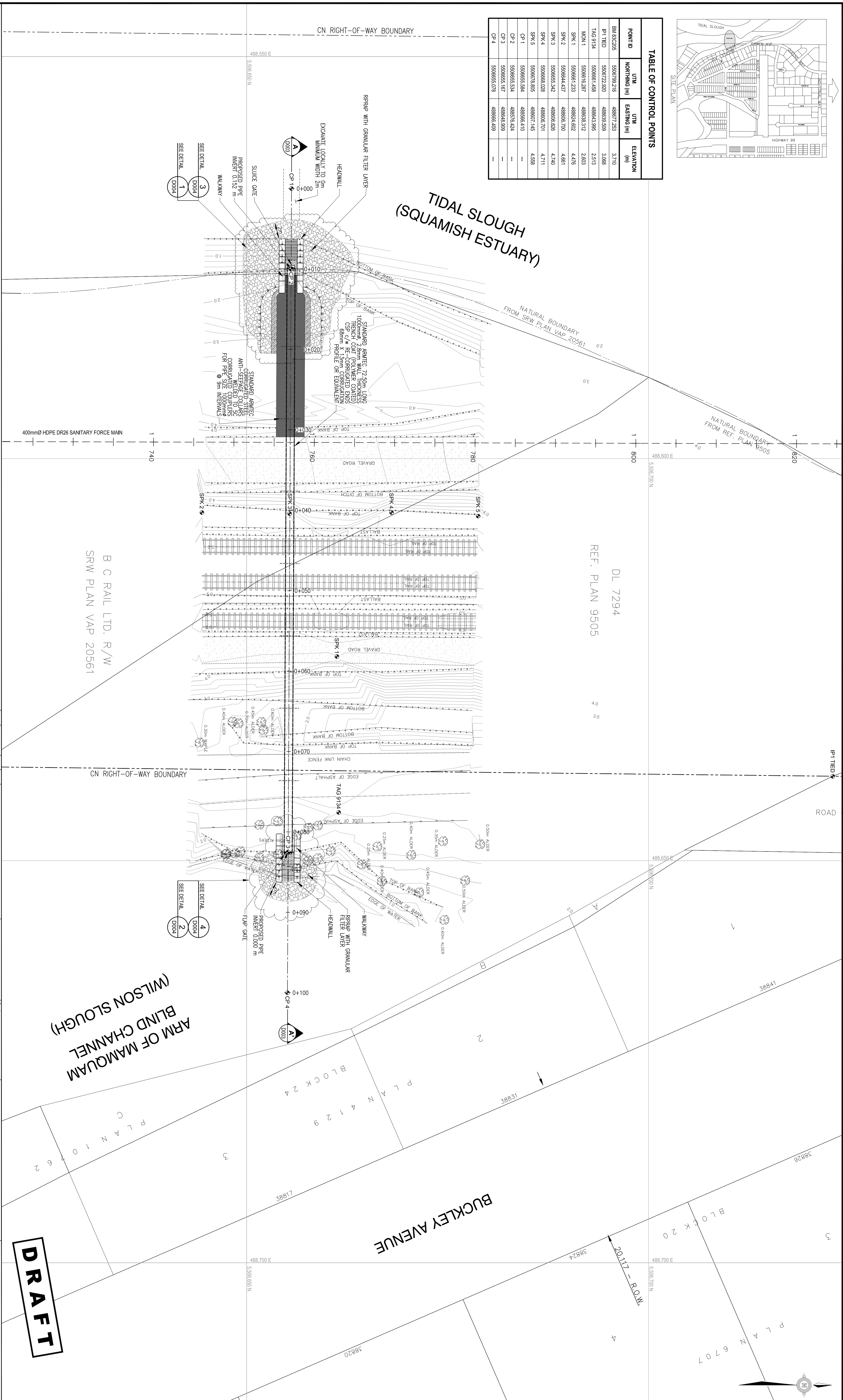

TABLE OF CONTROL POINTS			
POINT ID	UTM NORTHING (m)	UTM EASTING (m)	ELEVATION (m)
BM 83C205	5506799.216	488677.253	3.710
IP1 TIED	5506722.920	488639.599	3.089
TAG 9134	550681.458	48843.995	2.813
MON 1	5506816.287	48838.312	2.803
SPK 1	550681.233	48862.602	4.476
SPK 2	550684.437	48806.700	4.861
SPK 3	550685.342	48806.826	4.740
SPK 4	550688.028	48806.701	4.711
SPK 5	550679.805	48807.145	4.538
CP 1	5506855.884	48856.410	---
CP 2	550685.167	48846.309	---
CP 3	550685.167	48846.309	---
CP 4	550685.078	48866.409	---



DATUM - GEODETIC BENCHMARK
 MONUMENT COQA 431298 - TABLE# 83C205
 SITUATED IN SQUAMISH AREA
 RESIDENCE OF THE SPICKEY, 38876 BUCKLEY AVE (OLD GOVERNMENT ROAD),
 1.2 km NW OF JUNCTION WITH CLEVELAND AVE.
 TABLE IN SW OR FRONT CONCRETE FOUNDATION,
 21 cm FROM SOUTH CORNER 34 cm BELOW METAL SIDING.
 GEODETIC SURVEY OF CANADA PREPOSE LEVELS 1983, REV.#2

REFERENCE MATERIAL

- SITE SURVEY AND BASE DRAWING 06-130-BSEA.dwg, SUPPLIED BY R.F. BINNIE & ASSOCIATES LTD.
- LEGAL INFORMATION CONTAINED ON DRAWING 053.0375.dwg, SUPPLIED BY CN
- SMITHKORT FORKMAN INFORMATION CONTAINED ON DRAWING 144020501.dwg, SUPPLIED BY DISTRICT OF SQUAMISH

Rev.	DATE	BY	DESCRIPTION
1	JAN-10-2007	ML	AGC CHANGED CONCRETE SEWER COLLARS TO STANDARD WALKWAY ON ESTUARY SIDE UPDATED CONCRETE SEWER COLLAR NOTE WORKING; COLLAR SIZE & SPEC. CHANGED; LOOKBOOKS REMOVED
2	JAN-11-2007	ML	AGC CHANGED CONCRETE SEWER COLLS TO STANDARD WALKWAY ON ESTUARY SIDE UPDATED CONCRETE SEWER COLLAR NOTE WORKING; COLLAR SIZE & SPEC. CHANGED; LOOKBOOKS REMOVED
3	APR-3-2007	ML	AGC CHANGED WIDTH OF AND EXTENDED GRAVEL SURFACE PARALLEL TO EDGE OF EXISTING GRAVEL ROAD; ADDED 100mm CONCRETE CURB TO GRAVEL ROAD; ADDED 100mm CONCRETE CURB TO GRAVEL ROAD; ADDED 100mm CONCRETE CURB TO GRAVEL ROAD

Design	Checked	Approved	Drawn
ML	RE	ACC	REV/EJWB
2007.04.11	2007.04.11	2007.04.11	2007.04.11

HAY & COMPANY CONSULTANTS
 A DIVISION OF BEN
 HAY & COMPANY INC.
 Suite 1000, 1000 West Broadway, Vancouver, BC V6H 3G2
 Tel: 604.681.1111 Fax: 604.681.1112
 E-mail: hay@hayco.com

WILSON SLOUGH CULVERT

LAYOUT OF PROPOSED CULVERT CROSSING

Drawing No. 4810155 - D 0 0 2

Revision 3

DRAFT